

1 CG-202
1:30 TYPICAL KING BEDFRAME (TYPE D)
FRONT ELEVATION

3 CG-202
1:30 TYPICAL KING BEDFRAME (TYPE D)
SIDE ELEVATION

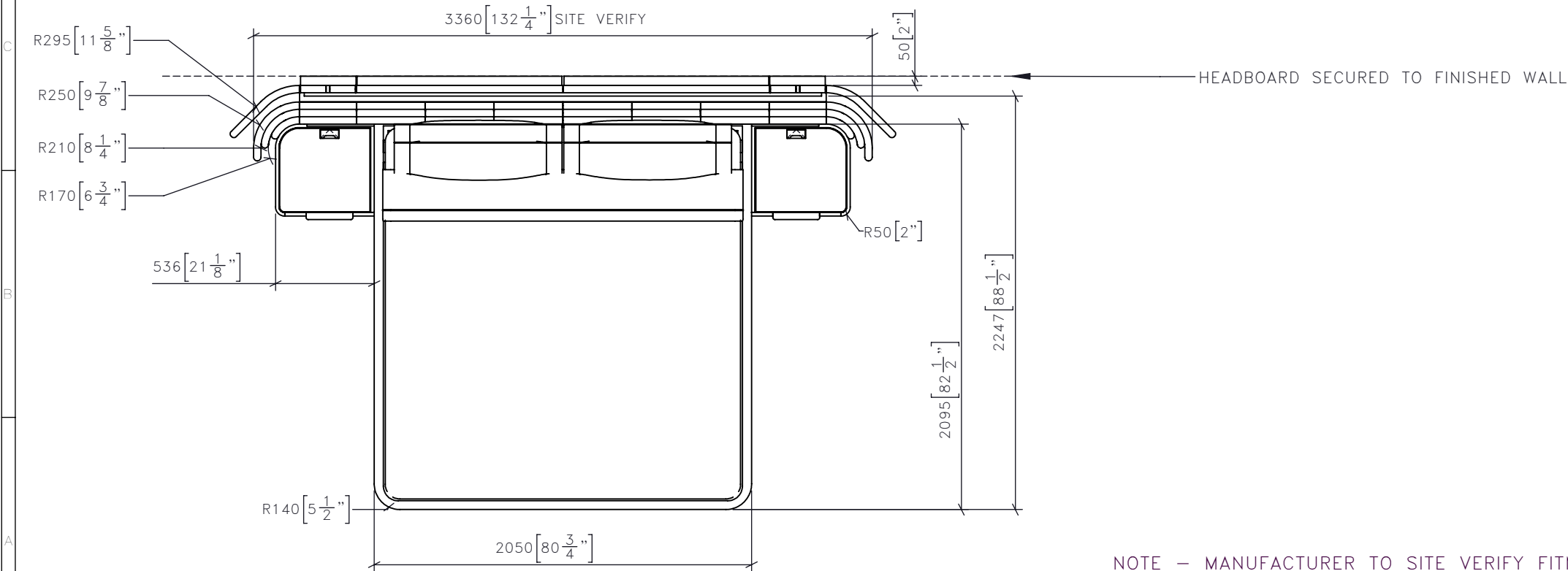

2 CG-202
1:30 TYPICAL KING BEDFRAME (TYPE D)
PLAN

NOTE - MANUFACTURER TO SITE VERIFY FITMENT OF CG-102
COMPONENTS IN ELEVATORS AND DOORWAYS
NOTE - MANUFACTURER TO ENSURE UNIT IS STABLE/SECURE FOR
HOSPITALITY USE

DRAWING ARE NOT TO BE SCALED. CONTRACTOR MUST CHECK AND VERIFY
ALL JOB DIMENSIONS, DRAWINGS, DETAILS AND SPECIFICATIONS; AND
REPORT ANY DISCREPANCIES TO DESIGNER BEFORE PROCEEDING WITH WORK.

-REV/	-ISSUED FOR	-DATE

STUDIO
MUNGE

25 WINGOLD AVENUE
TORONTO, ONTARIO
M6B 1P8 CANADA
416.588.1668
STUDIOMUNGE.COM

-SCALE
AS NOTED

-DATE
7/30/19

-DRAWN BY
LS

-CHECKED BY

-PROJECT NAME

MGM QINGDAO

-DRAWING TITLE

CG-202
TYPICAL KING BEDFRAME (TYPE D)

-PROJECT NUMBER
17126

-DRAWING NUMBER
1 / 6

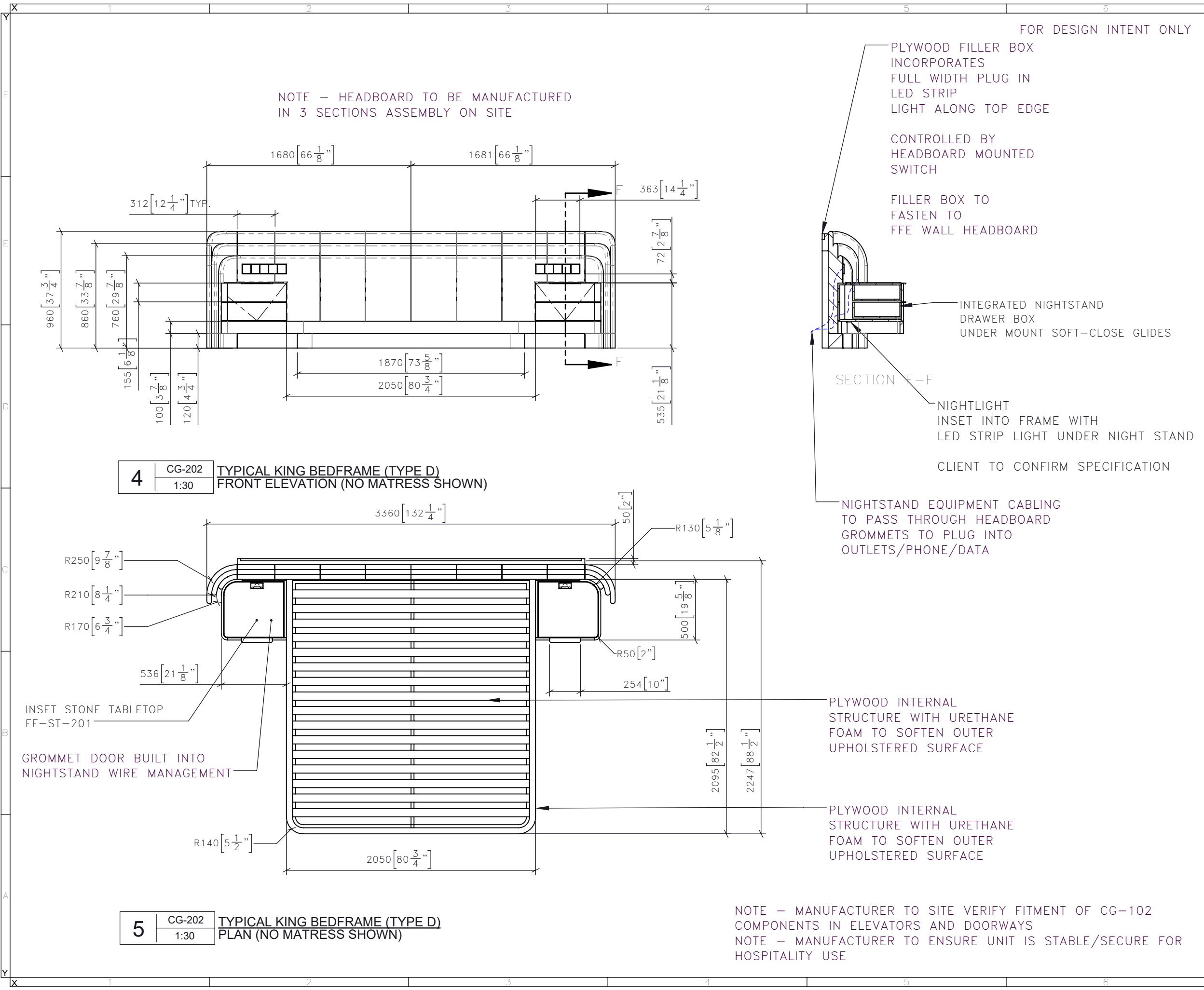

DRAWING ARE NOT TO BE SCALED. CONTRACTOR MUST CHECK AND VERIFY ALL JOB DIMENSIONS, DRAWINGS, DETAILS AND SPECIFICATIONS; AND REPORT ANY DISCREPANCIES TO DESIGNER BEFORE PROCEEDING WITH WORK.

—REV/	—ISSUED FOR	—DATE

STUDIO MUNGE

25 WINGOLD AVENUE
TORONTO, ONTARIO
M6B 1P8 CANADA
416.588.1668
STUDIOMUNGE.COM

—SCALE AS NOTED	—DATE 7/30/19
—DRAWN BY LS	—CHECKED BY
—PROJECT NAME MGM QINGDAO	
—DRAWING TITLE CG-202 TYPICAL KING BEDFRAME (TYPE D)	
—PROJECT NUMBER 17126	
—DRAWING NUMBER 2 / 6	

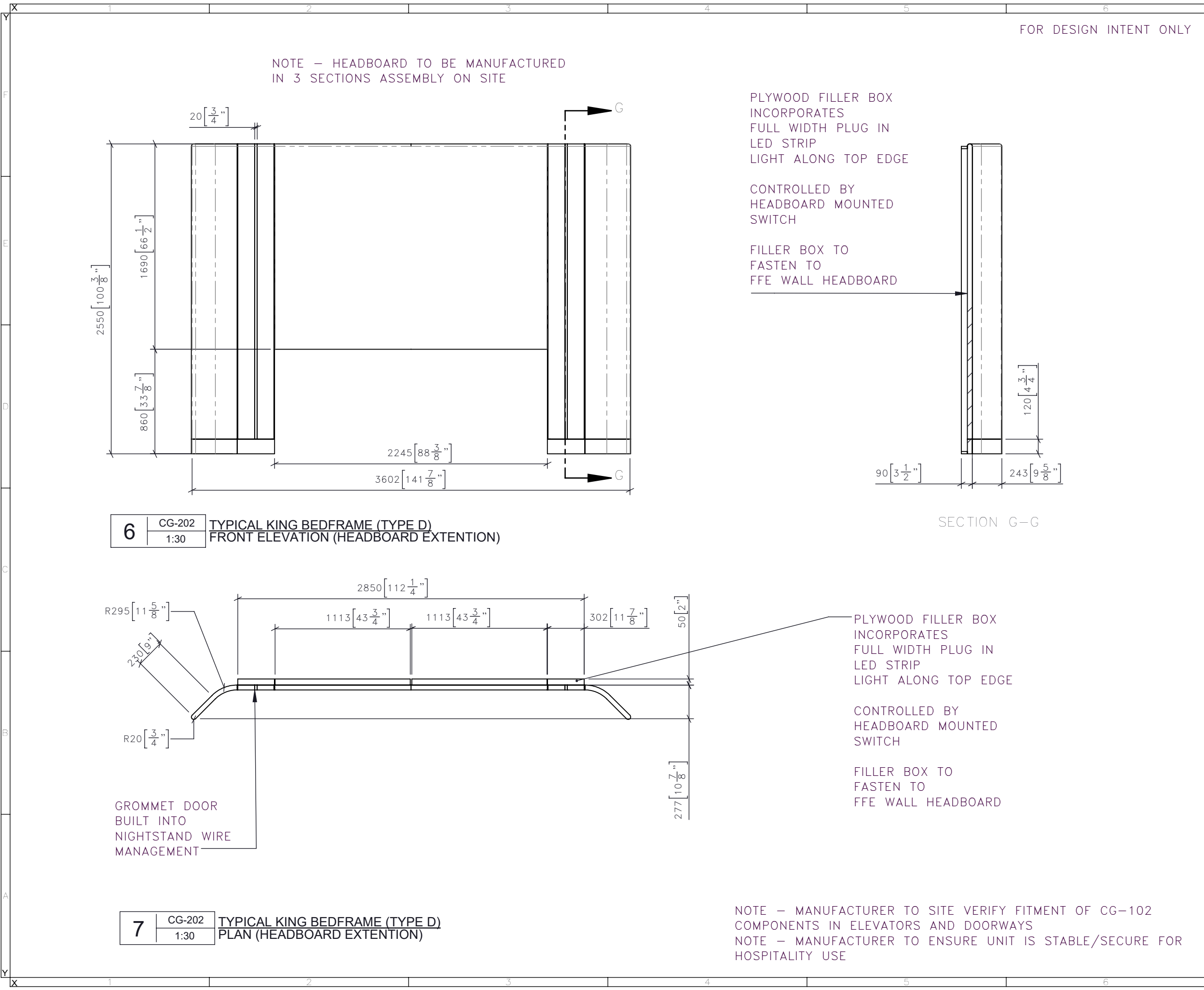

FOR DESIGN INTENT ONLY

NOTE – HEADBOARD TO BE MANUFACTURED
IN 3 SECTIONS ASSEMBLY ON SITE

PLYWOOD FILLER BOX
INCORPORATES
FULL WIDTH PLUG IN
LED STRIP
LIGHT ALONG TOP EDGE

CONTROLLED BY
HEADBOARD MOUNTED
SWITCH

FILLER BOX TO
FASTEN TO
FFE WALL HEADBOARD

SECTION G–G

6 CG-202 TYPICAL KING BEDFRAME (TYPE D)
1:30 FRONT ELEVATION (HEADBOARD EXTENTION)

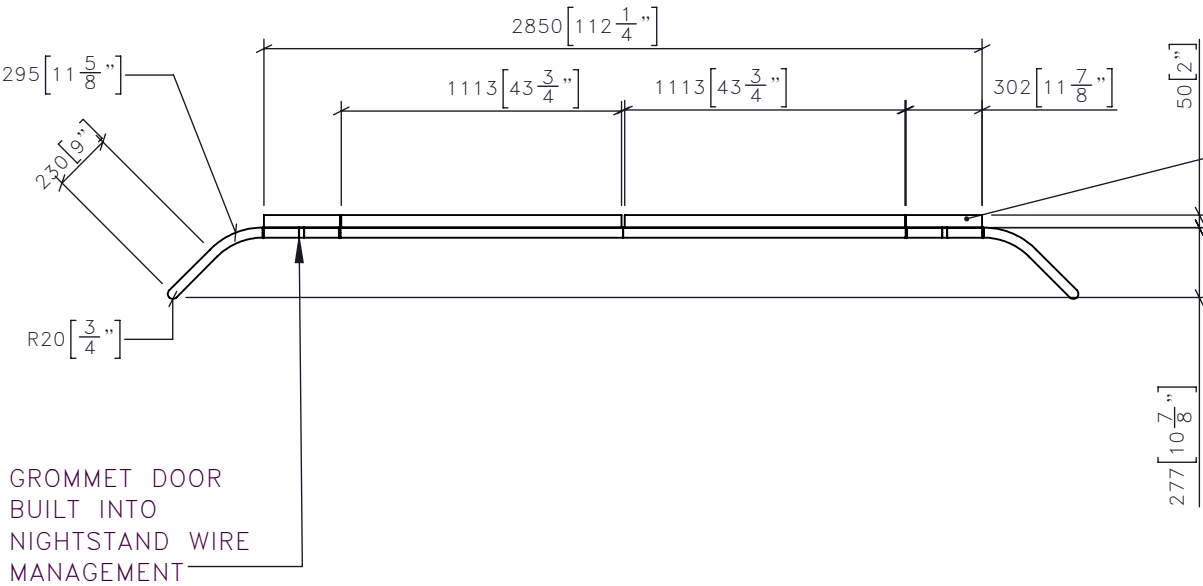

PLYWOOD FILLER BOX
INCORPORATES
FULL WIDTH PLUG IN
LED STRIP
LIGHT ALONG TOP EDGE

CONTROLLED BY
HEADBOARD MOUNTED
SWITCH

FILLER BOX TO
FASTEN TO
FFE WALL HEADBOARD

7 CG-202 TYPICAL KING BEDFRAME (TYPE D)
1:30 PLAN (HEADBOARD EXTENTION)

NOTE – MANUFACTURER TO SITE VERIFY FITMENT OF CG–102
COMPONENTS IN ELEVATORS AND DOORWAYS
NOTE – MANUFACTURER TO ENSURE UNIT IS STABLE/SECURE FOR
HOSPITALITY USE

DRAWING ARE NOT TO BE SCALED. CONTRACTOR MUST CHECK AND VERIFY
ALL JOB DIMENSIONS, DRAWINGS, DETAILS AND SPECIFICATIONS; AND
REPORT ANY DISCREPANCIES TO DESIGNER BEFORE PROCEEDING WITH WORK.

–REV/	–ISSUED FOR	–DATE

STUDIO
MUNGE

25 WINGOLD AVENUE
TORONTO, ONTARIO
M6B 1P8 CANADA
416.588.1668
STUDIOMUNGE.COM

–SCALE AS NOTED	–DATE 7/30/19
–DRAWN BY LS	–CHECKED BY
–PROJECT NAME MGM QINGDAO	
–DRAWING TITLE CG-202 TYPICAL KING BEDFRAME (TYPE D)	
–PROJECT NUMBER 17126	
–DRAWING NUMBER 3 / 6	

FOR DESIGN INTENT ONLY

DRAWING ARE NOT TO BE SCALED. CONTRACTOR MUST CHECK AND VERIFY ALL JOB DIMENSIONS, DRAWINGS, DETAILS AND SPECIFICATIONS; AND REPORT ANY DISCREPANCIES TO DESIGNER BEFORE PROCEEDING WITH WORK.

-REV/	-ISSUED FOR	-DATE

STUDIO
MUNGE

25 WINGOLD AVENUE
TORONTO, ONTARIO
M6B 1P8 CANADA
416.588.1668
STUDIOMUNGE.COM

-SCALE AS NOTED	-DATE 7/30/19
-DRAWN BY LS	-CHECKED BY
-PROJECT NAME	
MGM QINGDAO	
-DRAWING TITLE	
CG-202 TYPICAL KING BEDFRAME (TYPE D)	
-PROJECT NUMBER	
17126	
-DRAWING NUMBER	
4 / 6	

LIGHTING BY OTHERS
PROVIDE PROVISIONS FOR HIDDEN WIRE MANAGEMENT
REFER TO DRAWING
LT-101

FF-WD-202
TYP. HARDWOOD
HEADBOARD

FULL WIDTH PLUG IN
LED STRIP
LIGHT ALONG TOP EDGE

CHANNEL STITCH
DETAIL TYP.
SWITCH PLATE
CLIENT TO CONFIRM
SPECIFICATION

INTEGRATED
MOCKETT FOR
HIDDEN CABLE
MANAGEMENT

INSET STONE TABLETOP
FF-ST-201

CGF-202D
LEATHER
UPHOLSTERED
TIGHT/TAILORED
TYP. HARDWOOD
SIDE TABLE WITH
CUSTOM
METAL PULL

FF-ML-201
CUSTOM METAL
DRAWER PULL

UPHOLSTERY ARTWORK
PLEASE SEE SPEC

CGF-202E

FF-ML-201
METAL TRIM
SCONCE MOUNTING

CGF-202A
TIGHT UPHOLSTERED
LEATHER HEADBOARD

CGF-202B
TIGHT UPHOLSTERED
LEATHER HEADBOARD

CGF-202C
TIGHT UPHOLSTERED
LEATHER HEADBOARD

CGF-202D
TIGHT UPHOLSTERED
LEATHER HEADBOARD

CGF-202D
TIGHT UPHOLSTERED
LEATHER NIGHTSTAND

CGF-202D
LEATHER
UPHOLSTERED
TIGHT/TAILORED

NIGHTLIGHT
INSET INTO FRAME WITH
LED STRIP LIGHT UNDER NIGHT STAND

CLIENT TO CONFIRM SPECIFICATION

FF-PT-202
POWDER COAT KICK TO
MATCH CGF-202A

8 CG-202 TYPICAL KING BEDFRAME (TYPE D)
1:20 ISOMETRIC VIEW

NOTE - MANUFACTURER TO SITE VERIFY FITMENT OF CG-102
COMPONENTS IN ELEVATORS AND DOORWAYS
NOTE - MANUFACTURER TO ENSURE UNIT IS STABLE/SECURE FOR
HOSPITALITY USE

STUDIO MUNGE

X
Y
A
B
C
D
E
F
G
H
I
J
K
L
M
N
O
P
Q
R
S
T
U
V
W
X
Y



FOR DESIGN INTENT ONLY

DRAWING ARE NOT TO BE SCALED. CONTRACTOR MUST CHECK AND VERIFY ALL JOB DIMENSIONS, DRAWINGS, DETAILS AND SPECIFICATIONS; AND REPORT ANY DISCREPANCIES TO DESIGNER BEFORE PROCEEDING WITH WORK.

REV	ISSUED FOR	DATE

STUDIO
MUNGE

25 WINGOLD AVENUE
TORONTO, ONTARIO
M6B 1P8 CANADA
416.588.1668
STUDIOMUNGE.COM

SCALE	DATE
AS NOTED	7/30/19
DRAWN BY	CHECKED BY
LS	
PROJECT NAME	
MGM QINGDAO	
DRAWING TITLE	
CG-202 TYPICAL KING BEDFRAME (TYPE D)	
PROJECT NUMBER	
17126	
DRAWING NUMBER	
5 / 6	

STUDIO MUNGE

Y

1

2

3

4

5

6

X

1

2

3

4

5

6

Y

1

2

3

4

5

6

X

1

2

3

4

5

6

Y

1

2

3

4

5

6

X

1

2

3

4

5

6

Y

1

2

3

4

5

6

X

1

2

3

4

5

6

Y

1

2

3

4

5

6

X

1

2

3

4

5

6

Y

1

2

3

4

5

6

X

1

2

3

4

5

6

Y

1

2

3

4

5

6

FOR DESIGN INTENT ONLY

DRAWING ARE NOT TO BE SCALED. CONTRACTOR MUST CHECK AND VERIFY ALL JOB DIMENSIONS, DRAWINGS, DETAILS AND SPECIFICATIONS, AND REPORT ANY DISCREPANCIES TO DESIGNER BEFORE PROCEEDING WITH WORK.

REV	ISSUED FOR	DATE

STUDIO
MUNGE

25 WINGOLD AVENUE
TORONTO, ONTARIO
M6B 1P8 CANADA
416.588.1668
STUDIOMUNGE.COM

SCALE AS NOTED	DATE 7/30/19
DRAWN BY LS	CHECKED BY
PROJECT NAME	
MGM QINGDAO	
DRAWING TITLE	
CG-202 TYPICAL KING BEDFRAME (TYPE D)	
PROJECT NUMBER 17126	
DRAWING NUMBER 6 / 6	